

13/1
10/2



Coventry City Council
Application for a premises licence to be granted
under the Licensing Act 2003

PLEASE READ THE FOLLOWING INSTRUCTIONS FIRST

Before completing this form please read the guidance notes at the end of the form. If you are completing this form by hand please write legibly in block capitals. In all cases ensure that your answers are inside the boxes and written in black ink. Use additional sheets if necessary.

You may wish to keep a copy of the completed form for your records.

I/We HARJEET KAUR SANDHU
(Insert name(s) of applicant)

apply for a premises licence under section 17 of the Licensing Act 2003 for the premises described in Part 1 below (the premises) and I/we are making this application to you as the relevant licensing authority in accordance with section 12 of the Licensing Act 2003

Part 1 – Premises Details

Postal address of premises or, if none, ordnance survey map reference or description <u>106-108 CANNON HILL ROAD</u> <u>CANNAS PARK</u>			
Post town	<u>COVENTRY</u>	Postcode	<u>CV4 7BX</u>

Telephone number at premises (if any)	
Non-domestic rateable value of premises	<u>£ 6100</u>

Part 2 - Applicant Details

Please state whether you are applying for a premises licence as

Please tick as appropriate

- a) an individual or individuals * please complete section (A)
- b) a person other than an individual *
 - i. as a limited company please complete section (B)
 - ii. as a partnership please complete section (B)
 - iii. as an unincorporated association or please complete section (B)
 - iv. other (for example a statutory corporation) please complete section (B)

- c) a recognised club please complete section (B)
- d) a charity please complete section (B)
- e) the proprietor of an educational establishment please complete section (B)
- f) a health service body please complete section (B)
- g) a person who is registered under Part 2 of the Care Standards Act 2000 (c14) in respect of an independent hospital in Wales please complete section (B)
- ga) a person who is registered under Chapter 2 of Part 1 of the Health and Social Care Act 2008 (within the meaning of that Part) in an independent hospital in England please complete section (B)
- h) the chief officer of police of a police force in England and Wales please complete section (B)

* If you are applying as a person described in (a) or (b) please confirm:

Please tick yes

I am carrying on or proposing to carry on a business which involves the use of the premises for licensable activities; or

I am making the application pursuant to a
 statutory function or
 a function discharged by virtue of Her Majesty's prerogative

(A) INDIVIDUAL APPLICANTS (fill in as applicable)

Mr <input type="checkbox"/>	Mrs <input type="checkbox"/>	Miss <input checked="" type="checkbox"/>	Ms <input type="checkbox"/>	Other Title (for example, Rev)	
Surname SANDHU			First names HARJEET		
I am 18 years old or over				<input checked="" type="checkbox"/> Please tick yes	
Current postal address if different from premises address		[REDACTED]			
Post town	[REDACTED]		Postcode	[REDACTED]	
Daytime contact telephone number [REDACTED]					
E-mail address (optional)		[REDACTED]			

SECOND INDIVIDUAL APPLICANT (if applicable)

Mr <input type="checkbox"/>	Mrs <input type="checkbox"/>	Miss <input type="checkbox"/>	Ms <input type="checkbox"/>	Other Title (for example, Rev)	
Surname			First names		
I am 18 years old or over				<input type="checkbox"/>	Please tick yes
Current postal address if different from premises address					
Post town				Postcode	
Daytime contact telephone number					
E-mail address (optional)					

(B) OTHER APPLICANTS

Please provide name and registered address of applicant in full. Where appropriate please give any registered number. In the case of a partnership or other joint venture (other than a body corporate), please give the name and address of each party concerned.

Name
Address
Registered number (where applicable)
Description of applicant (for example, partnership, company, unincorporated association etc.)
Telephone number (if any)
E-mail address (optional)

Part 3 Operating Schedule

When do you want the premises licence to start?

DD	MM	YYYY
┆	┆	┆
┆	┆	┆
┆	┆	┆

If you wish the licence to be valid only for a limited period, when do you want it to end?

DD	MM	YYYY
┆	┆	┆
┆	┆	┆
┆	┆	┆

Please give a general description of the premises (please read guidance note 1)

OFF LICENCE (CONV - STORE)

If 5,000 or more people are expected to attend the premises at any one time, please state the number expected to attend.

What licensable activities do you intend to carry on from the premises?

(Please see sections 1 and 14 of the Licensing Act 2003 and Schedules 1 and 2 to the Licensing Act 2003)

Provision of regulated entertainment

Please tick any that apply

- a) plays (if ticking yes, fill in box A)
- b) films (if ticking yes, fill in box B)
- c) indoor sporting events (if ticking yes, fill in box C)
- d) boxing or wrestling entertainment (if ticking yes, fill in box D)
- e) live music (if ticking yes, fill in box E)
- f) recorded music (if ticking yes, fill in box F)
- g) performances of dance (if ticking yes, fill in box G)
- h) anything of a similar description to that falling within (e), (f) or (g) (if ticking yes, fill in box H)

Provision of late night refreshment (if ticking yes, fill in box I)

Supply of alcohol (if ticking yes, fill in box J)

In all cases complete boxes K, L and M

A

Plays Standard days and timings (please read guidance note 6)			Will the performance of a play take place indoors or outdoors or both – please tick (please read guidance note 2)	Indoors	<input type="checkbox"/>
Day	Start	Finish		Outdoors	<input type="checkbox"/>
				Both	<input type="checkbox"/>
Mon			Please give further details here (please read guidance note 3)		
Tue					
Wed			State any seasonal variations for performing plays (please read guidance note 4)		
Thur					
Fri			Non standard timings. Where you intend to use the premises for the performance of plays at different times to those listed in the column on the left, please list (please read guidance note 5)		
Sat					
Sun					

B

Films Standard days and timings (please read guidance note 6)			<u>Will the exhibition of films take place indoors or outdoors or both – please tick</u> (please read guidance note 2)	Indoors	<input type="checkbox"/>			
				Outdoors	<input type="checkbox"/>			
				Both	<input type="checkbox"/>			
Day	Start	Finish	<u>Please give further details here</u> (please read guidance note 3)					
Mon								
Tue								
Wed						<u>State any seasonal variations for the exhibition of films</u> (please read guidance note 4)		
Thur								
Fri						<u>Non standard timings. Where you intend to use the premises for the exhibition of films at different times to those listed in the column on the left, please list</u> (please read guidance note 5)		
Sat								
Sun								

D

Boxing or wrestling entertainments Standard days and timings (please read guidance note 6)			<u>Will the boxing or wrestling entertainment take place indoors or outdoors or both – please tick</u> (please read guidance note 2)	Indoors	<input type="checkbox"/>
				Outdoors	<input type="checkbox"/>
				Both	<input type="checkbox"/>
Day	Start	Finish	<u>Please give further details here</u> (please read guidance note 3)		
Mon					
Tue			<u>State any seasonal variations for boxing or wrestling entertainment</u> (please read guidance note 4)		
Wed					
Thur			<u>Non standard timings. Where you intend to use the premises for boxing or wrestling entertainment at different times to those listed in the column on the left, please list</u> (please read guidance note 5)		
Fri					
Sat					
Sun					

C

Indoor sporting events Standard days and timings (please read guidance note 6)			<u>Please give further details</u> (please read guidance note 3)
Day	Start	Finish	
Mon			
Tue			<u>State any seasonal variations for indoor sporting events</u> (please read guidance note 4)
Wed			
Thur			<u>Non standard timings. Where you intend to use the premises for indoor sporting events at different times to those listed in the column on the left, please list</u> (please read guidance note 5)
Fri			
Sat			
Sun			

E

Live music Standard days and timings (please read guidance note 6)			Will the performance of live music take place indoors or outdoors or both – please tick (please read guidance note 2)	Indoors	<input type="checkbox"/>
				Outdoors	<input type="checkbox"/>
				Both	<input type="checkbox"/>
Day	Start	Finish	Please give further details here (please read guidance note 3)		
Mon					
Tue			State any seasonal variations for the performance of live music (please read guidance note 4)		
Wed					
Thur			Non standard timings. Where you intend to use the premises for the performance of live music at different times to those listed in the column on the left, please list (please read guidance note 5)		
Fri					
Sat					
Sun					

F

Recorded music Standard days and timings (please read guidance note 6)			Will the playing of recorded music take place indoors or outdoors or both – please tick (please read guidance note 2)	
			Indoors	<input type="checkbox"/>
			Outdoors	<input type="checkbox"/>
			Both	<input type="checkbox"/>
Day	Start	Finish	Please give further details here (please read guidance note 3)	
Mon				
Tue				
Wed				
Thur				
Fri				
Sun				
			State any seasonal variations for the playing of recorded music (please read guidance note 4)	
			Non standard timings. Where you intend to use the premises for the playing of recorded music at different times to those listed in the column on the left, please list (please read guidance note 5)	

G

Performances of dance Standard days and timings (please read guidance note 6)			<u>Will the performance of dance take place indoors or outdoors or both – please tick</u> (please read guidance note 2)		Indoors	<input type="checkbox"/>
					Outdoors	<input type="checkbox"/>
					Both	<input type="checkbox"/>
Day	Start	Finish	<u>Please give further details here</u> (please read guidance note 3)			
Mon						
Tue						
Wed			<u>State any seasonal variations for the performance of dance</u> (please read guidance note 4)			
Thur						
Fri			<u>Non standard timings. Where you intend to use the premises for the performance of dance at different times to those listed in the column on the left, please list</u> (please read guidance note 5)			
Sat						
Sun						

H

Anything of a similar description to that falling within (e), (f) or (g) Standard days and timings (please read guidance note 6)			Please give a description of the type of entertainment you will be providing		
Day	Start	Finish	<u>Will this entertainment take place indoors or outdoors or both – please tick</u> (please read guidance note 2)	Indoors	<input type="checkbox"/>
Mon				Outdoors	<input type="checkbox"/>
				Both	<input type="checkbox"/>
Tue			<u>Please give further details here</u> (please read guidance note 3)		
Wed					
Thur			<u>State any seasonal variations for entertainment of a similar description to that falling within (e), (f) or (g)</u> (please read guidance note 4)		
Fri					
Sat			<u>Non standard timings. Where you intend to use the premises for the entertainment of a similar description to that falling within (e), (f) or (g) at different times to those listed in the column on the left, please list</u> (please read guidance note 5)		
Sun					



I

Late night refreshment Standard days and timings (please read guidance note 6)			Will the provision of late night refreshment take place indoors or outdoors or both – please tick (please read guidance note 2)	Indoors	<input type="checkbox"/>
				Outdoors	<input type="checkbox"/>
				Both	<input type="checkbox"/>
Day	Start	Finish	<u>Please give further details here</u> (please read guidance note 3)		
Mon					
Tue			<u>State any seasonal variations for the provision of late night refreshment</u> (please read guidance note 4)		
Wed					
Thur			<u>Non standard timings. Where you intend to use the premises for the provision of late night refreshment at different times, to those listed in the column on the left, please list</u> (please read guidance note 5)		
Fri					
Sat					
Sun					

J

Supply of alcohol Standard days and timings (please read guidance note 6)			Will the supply of alcohol be for consumption – please tick (please read guidance note 7)	On the premises	<input type="checkbox"/>			
				Off the premises	<input checked="" type="checkbox"/>			
				Both	<input type="checkbox"/>			
Day	Start	Finish	State any seasonal variations for the supply of alcohol (please read guidance note 4)					
Mon	7.30	10PM						
Tue	7.30	10PM						
Wed	7.30	10PM						
Thur	7.30	10PM				Non standard timings. Where you intend to use the premises for the supply of alcohol at different times to those listed in the column on the left, please list (please read guidance note 5)		
Fri	7.30	10PM						
Sat	7.30	10PM						
Sun	7.30	10PM						

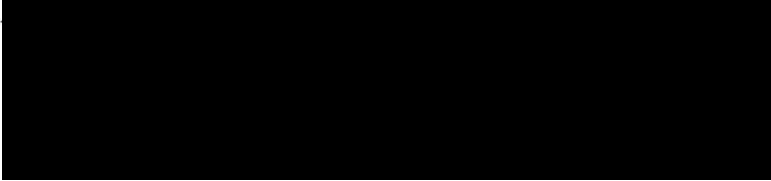
State the name and details of the individual whom you wish to specify on the licence as designated premises supervisor:

Name	HARJEET KAUR SANDHU
	
Postcode	
Personal licence number (if known)	
Issuing licensing authority (if known)	

K

Please highlight any adult entertainment or services, activities, other entertainment or matters ancillary to the use of the premises that may give rise to concern in respect of children (please read guidance note 8).

L

Hours premises are open to the public Standard days and timings (please read guidance note 6)			State any seasonal variations (please read guidance note 4)
Day	Start	Finish	
Mon	7.30	10pm	Non standard timings. Where you intend the premises to be open to the public at different times from those listed in the column on the left, please list (please read guidance note 5)
Tue	7.30	10PM	
Wed	7.30	10 PM	
Thur	7.30	10PM	
Fri	7.30	10PM	
Sat	7.30	10PM	
Sun	7.30	10PM	

M Describe the steps you intend to take to promote the four licensing objectives:

b) The prevention of crime and disorder

we will implement the challenge 25 - photo I-d. required.
Keep a register - of under age / people refused to be
sold ~~at the~~ alcohol. (Keep refusal slips from the
till). CCTV shall be installed. All staff shall be trained
in knowledge of the law, all procedures and how to keep
the refusal slips and logs. To display correct signage.

c) Public safety

To keep a check on the premises outside, especially
if we suspect adults buying alcohol for the underage.
Any suspicious activities shall be reported to the police.
Also to keep a log on suspicious activities. CCTV
coverage should also be kept.

d) The prevention of public nuisance

To keep noise to a minimum, not have deliveries to the
shop after 6pm. To keep the shop door closed with
evening and any music or radio played in the shop
to be kept at a low volume. To display notices outside
the shop requesting customers respect local residents.
Banning customers ~~to~~ ^{who} cause problems continuously in the shop.

e) The protection of children from harm

To refuse the sale of alcohol to underage. To ensure children
are supervised ~~with~~ by adults. Any concerns about
children must be reported to the police or the children
social care duty team. To ensure the fittings in the shop
are safe. To train all staff in the shop in age verification
and make sure they understand how to report a concern.

To work along the HSCB to safeguard children.

Checklist:

Please tick to indicate agreement

- I have made or enclosed payment of the fee.
- I have enclosed the plan of the premises.
- I have sent copies of this application and the plan to responsible authorities and others where applicable.
- I have enclosed the consent form completed by the individual I wish to be designated premises supervisor, if applicable.

- I understand that I must now advertise my application.
- I understand that if I do not comply with the above requirements my application will be rejected.

IT IS AN OFFENCE, LIABLE ON SUMMARY CONVICTION TO A FINE NOT EXCEEDING LEVEL 5 ON THE STANDARD SCALE, UNDER SECTION 158 OF THE LICENSING ACT 2003, TO MAKE A FALSE STATEMENT IN OR IN CONNECTION WITH THIS APPLICATION.

Part 4 – Signatures (please read guidance note 10)

Signature of applicant or applicant’s solicitor or other duly authorised agent (see guidance note 11).
If signing on behalf of the applicant, please state in what capacity.



Signature	
Date	8/1/15
Capacity	

For joint applications, signature of 2nd applicant or 2nd applicant’s solicitor or other authorised agent (please read guidance note 12). **If signing on behalf of the applicant, please state in what capacity.**

Signature	
Date	
Capacity	

Contact name (where not previously given) and postal address for correspondence associated with this application (please read guidance note 13)



Post town		Postcode	
Telephone number (if any)			
If you would prefer us to correspond with you by e-mail, your e-mail address (optional)			

Notes for Guidance

1. Describe the premises, for example the type of premises, its general situation and layout and any other information which could be relevant to the licensing objectives. Where your application includes off-supplies of alcohol and you intend to provide a place for consumption of these off-supplies, you must include a description of where the place will be and its proximity to the premises.
2. Where taking place in a building or other structure please tick as appropriate (indoors may include a tent).

3. For example the type of activity to be authorised, if not already stated, and give relevant further details, for example (but not exclusively) whether or not music will be amplified or unamplified.
4. For example (but not exclusively), where the activity will occur on additional days during the summer months.
5. For example (but not exclusively), where you wish the activity to go on longer on a particular day e.g. Christmas Eve.
6. Please give timings in 24 hour clock (e.g. 16:00) and only give details for the days of the week when you intend the premises to be used for the activity.
7. If you wish people to be able to consume alcohol on the premises, please tick 'on the premises'. If you wish people to be able to purchase alcohol to consume away from the premises, please tick 'off the premises'. If you wish people to be able to do both, please tick 'both'.
8. Please give information about anything intended to occur at the premises or ancillary to the use of the premises which may give rise to concern in respect of children, regardless of whether you intend children to have access to the premises, for example (but not exclusively) nudity or semi-nudity, films for restricted age groups or the presence of gaming machines.
9. Please list here steps you will take to promote all four licensing objectives together.
10. The application form must be signed.
11. An applicant's agent (for example solicitor) may sign the form on their behalf provided that they have actual authority to do so.
12. Where there is more than one applicant, each of the applicant or their respective agent must sign the application form.
13. This is the address which we shall use to correspond with you about this application.

Consent of individual to being specified as premises supervisor

I MISS HARJEET KOUR SANDHU
[full name of prospective premises supervisor]

of 106-108 CANNON HILL ROAD
CANNON PARK ROAD
COVENTRY
CV4 7BX (BUSINESS)

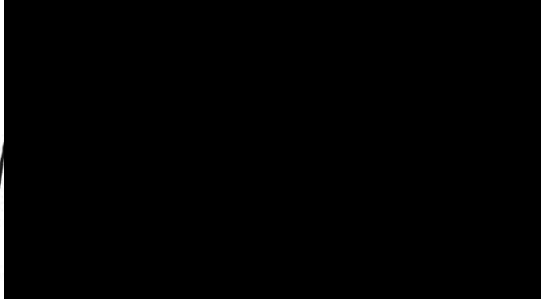

[home address of prospective premises supervisor]

hereby confirm that I give my consent to be specified as the designated premises supervisor in relation to the application for

OFF LICENCE
[type of application]

by

MISS HARJEET KOUR SANDHU
[name of applicant]

relating to a premises licence *[number of existing licence, if any]*

for 106-108 CANNON HILL ROAD
CANNON PARK ROAD
COVENTRY
CV4 7BX

[name and address of premises to which the application relates]

and any premises licence to be granted or varied in respect of this application made by

MISS HARJEET KAUR SANDHU
[name of applicant]

concerning the supply of alcohol at

106-108 CANNON HILL ROAD
CANNON HILL
COVENTRY
CV4 7BX

[name and address of premises to which application relates]

I also confirm that I am applying for, intend to apply for or currently hold a personal licence, details of which I set out below.

Personal licence number

[insert personal licence number, if any]

Personal licence issuing authority

[insert name and address and telephone number of personal licence issuing authority, if any]

Signed

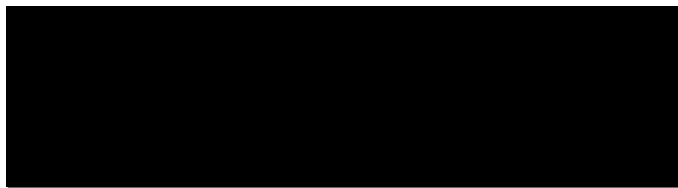

Name (please print)

HARJEET KAUR SANDHU

Date

5/1/15

THIS DRAWING HAS BEEN REPRODUCED FROM THE ORIGINAL SET. ANY CHANGES TO THIS DRAWING MUST BE MADE TO THE ORIGINAL SET.

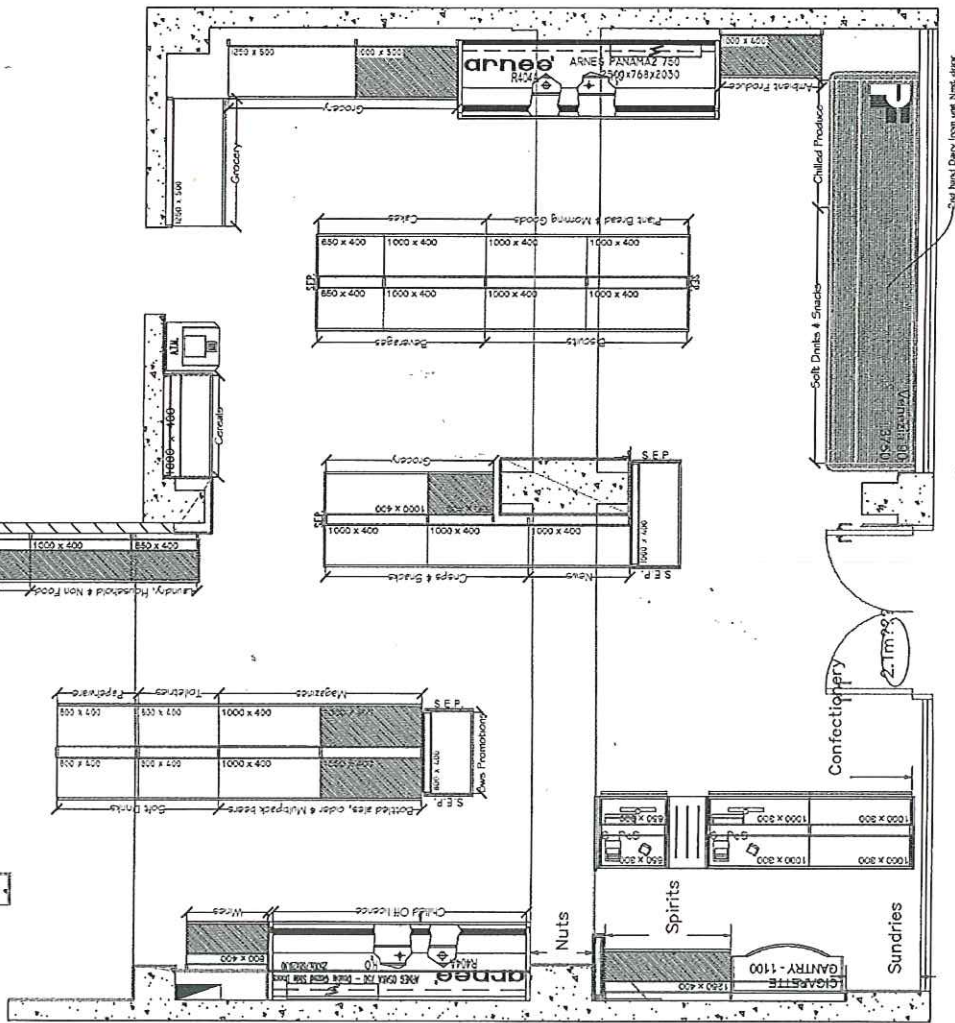

2nd hand shelving in ivory from inter next door.



DRAWING TITLE PROPOSED COSTCUTTER CANNON HILL ROAD COVENTRY		DATE 29.10.2014	
SCALE 1/50 @ A3	DRAWING NO	REVISIONS	
DRAWN DF			

Costcutter
 HARVEST MILLS, COMPTONWOOD, DUNNINGTON, YORK. YO19
 5FY
 TELEPHONE: 01904 488663 FAX 01904 489828

© Copyright

Masih, Rekha

From: Harj SANDHU <harjeetsandhu@hotmail.co.uk>
Sent: 29 January 2015 10:03
To: Joanne Bowes
Cc: Masih, Rekha
Subject: Re: 106-108 Cannon Hill Road

This is fine we are in agreement with this

Sent from my iPhone

On 26 Jan 2015, at 04:46 pm, "Joanne Bowes" <j.bowes@west-midlands.pnn.police.uk> wrote:

Good Afternoon Harjeet,

Further to our meeting today could you please confirm we have agreed the following conditions for Cannon Hill Road:

- (1) CCTV will operate at the premises to the agreed standard of the West Midlands Police. Images will be retained for a minimum of 28days and be made available to download at the request of the responsible authorities.
- (2) A refusals/ incident book will be implemented at the premises.
- (3) All staff will be trained in basic licensing laws. This will be documented and refreshed on a 6 monthly basis.
- (4) Challenge 25 will operate at the premises.

Kind Regards

PC Jo Bowes

This email is intended for the addressee only and may contain privileged or confidential information. If received in error, please notify the originator immediately. Any unauthorised use, disclosure, copying or alteration of this email is strictly forbidden. Views or opinions expressed in this email do not necessarily represent those of West Midlands Police. All West Midlands Police email activity is monitored for virus, racist, obscene, or otherwise inappropriate activity. No responsibility is accepted by West Midlands Police for any loss or damage arising in any way from the receipt or use of this email.

All e-mails are monitored by Coventry City Council's ICT Security, using MailMeter and Mimecast in accordance with the Regulations of Investigatory Powers Act 2000.